

COLLECTIVE MARKS:

Gaits (freedom and regularity).				
Impulsion (desire to move forward with suppleness of the back and steady tempo).				
Submission (acceptance of steady contact, attention, and confidence).	2			
Rider's position (keeping in balance with horse).				
Rider's effectiveness of aids (correct bend and preparation of transitions).				
Geometry and accuracy (correct size and shape of circles and turns).				

160
160 SUBTOTAL _____
 ERRORS (-) _____
 TOTAL POINTS _____

FURTHER REMARKS:

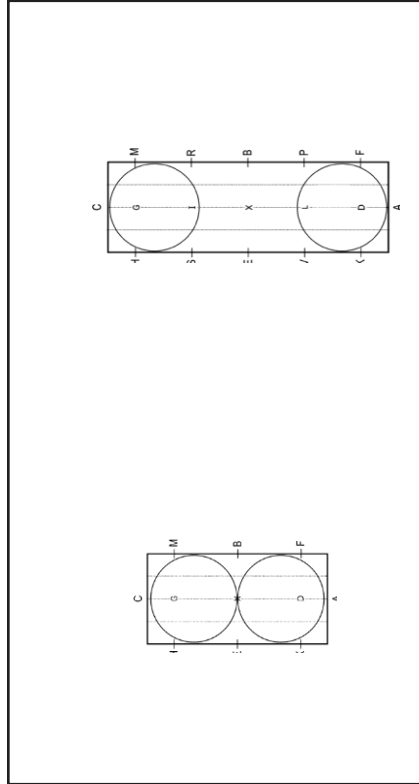

To be deducted
 Errors of the course and omissions
 are penalized 1st Time = 2 points
 2nd Time = 4 points
 3rd Time = Elimination

©2022 United State Dressage Federation. All Rights reserved. Reproduction without permission is prohibited by law. USDF is not responsible for any errors or omissions in the publication nor for the use of its copyrighted materials in any

UNITED STATES DRESSAGE FEDERATION™
2023
INTRODUCTORY LEVEL – TEST A
WALK—FLAT WALK

TWH
 INTRODUCTORY
 LEVEL TEST

A

This unique series of tests provides an opportunity for the horse and/or rider new to dressage to demonstrate elementary skills. The tests have been designed to encourage correct performance and to prepare the horse for the transition to the USEF tests.

SUGGESTED SCHEDULING TIME
 5:00 Standard Arena
 4:00 Small Arena
 (Possibly longer for schooling shows)

INSTRUCTION:
 Transitions from walk to flat walk and flat walk to walk may be performed through sitting trot with the objective of performing a smooth transition.

- Turns from center line to long side and long side to center line should be ridden as a half circle, touching the track at a point midway between the center line and the corner, and vice versa.

COMMENT:
 Horses should be ridden on a light but steady contact, with the exception of the free walk in which the horse is allowed complete freedom to stretch neck forward and downward.

WHOA & TWHBEA
Class 267

 Name of Competition

 Class

 Date

 Number and Name of Horse

 Name of Rider

MAXIMUM POSSIBLE POINTS: 160

FINAL SCORE

 Points _____ Percent

 Name of Judge/Position

 Signature of Judge

2023 TWH GAITED DRESSAGE INTRODUCTORY LEVEL - TEST A
WALK-FLAT WALK

REQUIREMENTS:
 Free walk
 Medium walk
 Flat walk
 20 meter circle
 Halt through walk

PURPOSE: To introduce the rider and/or horse to the sport of dressage, confirming that they are beginning to develop an understanding of correct dressage basics. The horse should be ridden freely forward in a steady tempo and clear rhythm, accepting contact with the bit. An understanding of test accuracy and geometry should be demonstrated.

NO.

TEST		DIRECTIVE IDEAS	POINTS	COEF	TOTAL	REMARKS
1.	A Between X & C	Enter, flat walk Medium walk	Regularity, quality of flat walk; straightness, willing, calm transition. Regularity, quality, of walk			
2.	C M	Track right Flat walk	Bend and balance; willing, calm transition			
3.	A	Circle right 20 meters, flat walk	Regularity; shape and size of circle; bend; balance			
4.	K-X-M	Change rein, flat walk	Regularity of flat walk; straightness; bend and balance in corner			
5.	C	Circle left 20 meters, flat walk	Regularity; shape and size of circle; bend; balance			
6.	Between C & H	Medium walk	Willing, calm transition; regularity, quality			
7.	H-X-F	Free walk	Regularity, reach and ground cover with over track of free walk allowing complete freedom to stretch the neck forward and downward			
8.	F-A A	Medium walk Down center line	Regularity, quality, willing, calm transition, bend and balance in turn Straightness on center line.			
9.	X	Halt and salute	Straightness; attentiveness; immobility (min. 3 seconds)			

Leave arena in free walk. Exit at A.